

Product Specification

Ord.-No.: **111 697 S1 / E0680497**



Specification: Connecting clamp for reinforcement, V2A fl.
30-40 mm and Ø 10 mm/Ø 20-40 mm

Performance: Connecting clamp according to DIN EN 62561-1 for the connection of round and flat conductors with the reinforcement in the concrete foundation.

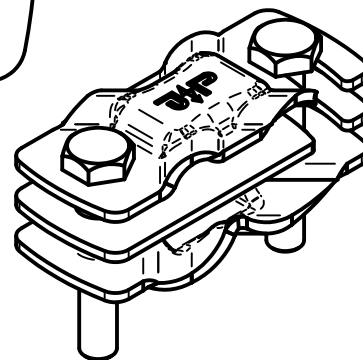
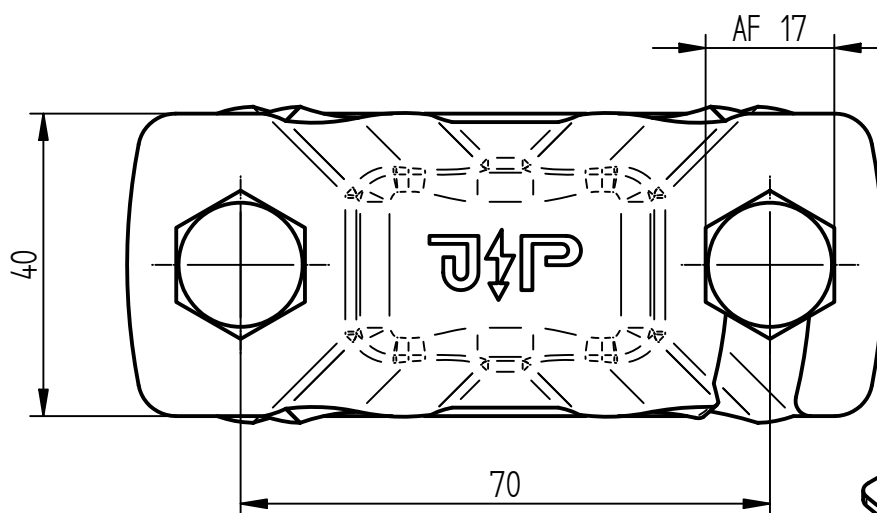
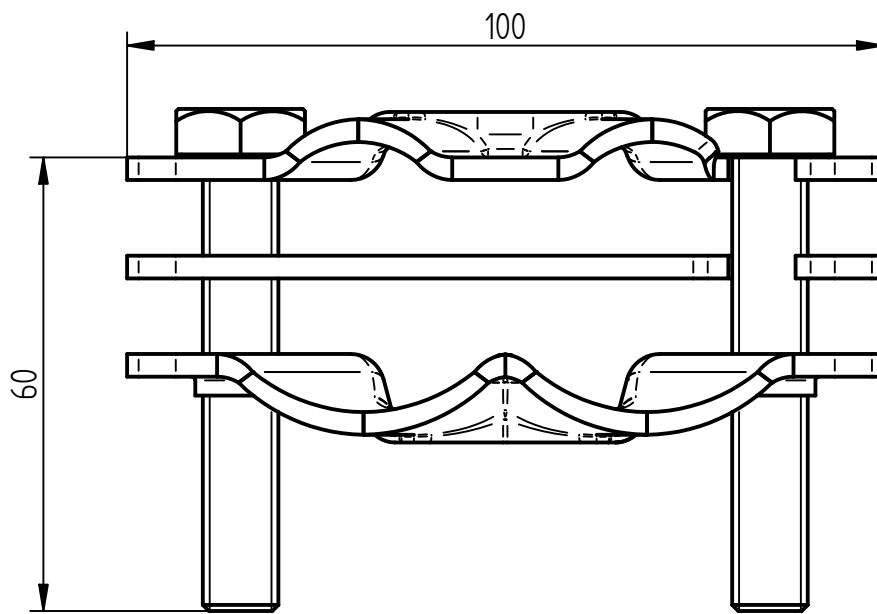

Material	Stainless steel V2A
Typ of clamp	three-part, flat/round and round/round
Fit of conductor	fl. 30-40 mm and/or Ø 10 mm
Fit of reinforcement	Ø 20-40 mm
Screw	[2x] Hexagon screw M10, Stainless steel V2A
Weight	320 g
Standard reference	DIN EN 62561-1
Packing unit	25 unit